

## Francis Dardis

---

**From:** Kristian McCombs <kristian.mccombs@hdgpx.com>  
**Sent:** Wednesday, May 10, 2023 1:14 PM  
**To:** Francis Dardis; Eric Jacobson; Alex Aleman; Jennifer Nye  
**Cc:** Andrew Xu  
**Subject:** RE: Elmonica development

Hi Francis,

The proposed location and invert elevation will work on our development side. Let us know if you need any further confirmation for land use.

Thank you,

Kristian McCombs, PE  
Associate, Project Engineer  
D: 503.946.5358 | O: 503.946.6690

*Humber Design Group, Inc.*  
*Urban Civil Engineering*

---

**From:** Francis Dardis <francisd@ankrommoisan.com>  
**Sent:** Wednesday, May 10, 2023 10:26 AM  
**To:** Kristian McCombs <kristian.mccombs@hdgpx.com>; Eric Jacobson <ejacobson@reachcdc.org>; Alex Aleman <aaleman@reachcdc.org>; Jennifer Nye <jnye@salazarch.com>  
**Cc:** Andrew Xu <andrew.xu@hdgpx.com>  
**Subject:** RE: Elmonica development

Thanks, Kristian-

I think there's plenty of wiggle room NOW if you can't move the connection point farther south.

This is what's going on with that pipe on our drawings; safe to say that we haven't coordinated on this in quite a while.

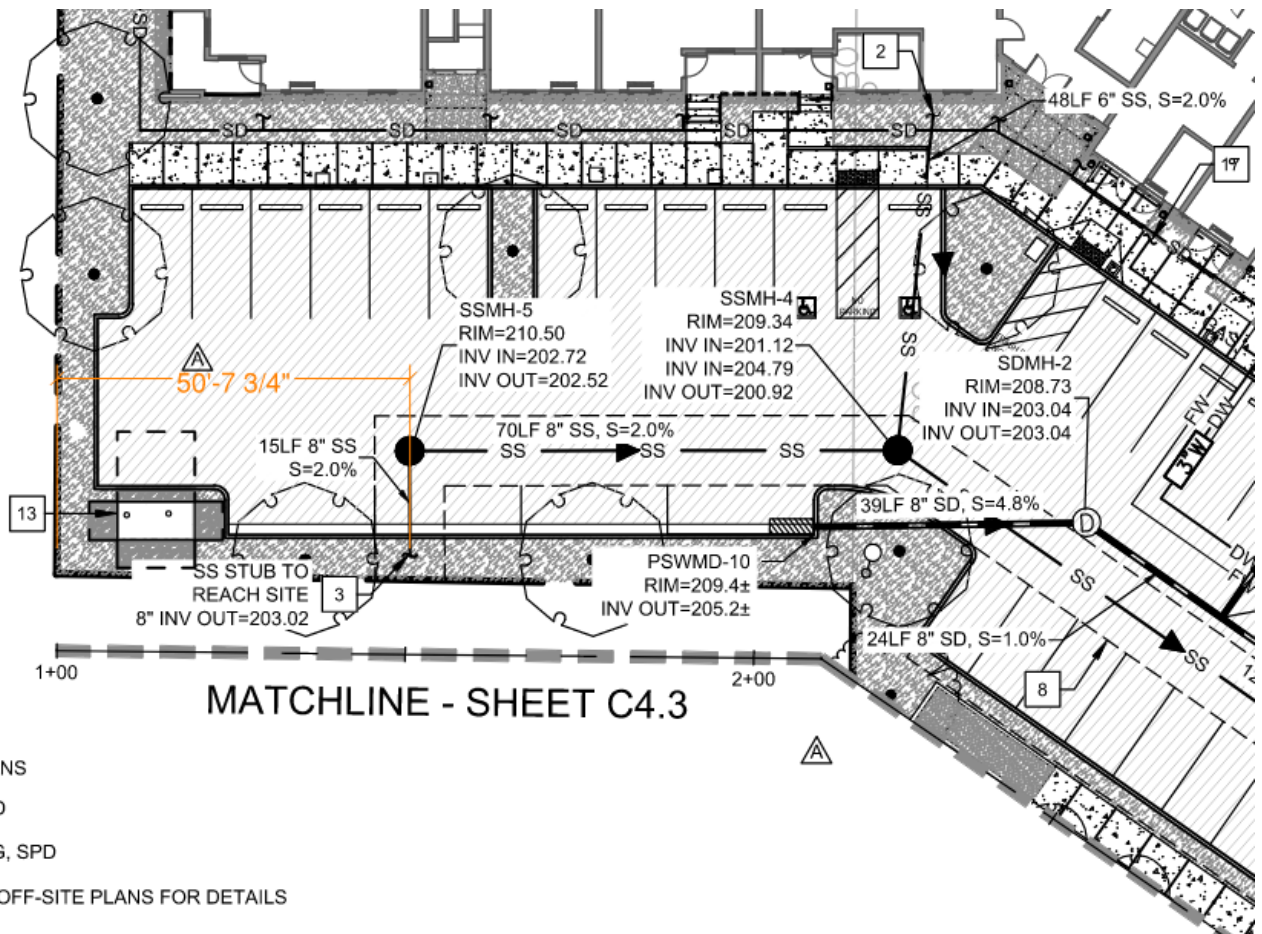

EE OFFSITE PLANS

CONNECTION, SPD

CONNECTION TO BUILDING, SPD

GAS MAIN, SEE OFF-SITE PLANS FOR DETAILS

## Francis Dardis

ASSOCIATE PRINCIPAL, AIA

O +1 (503) 245-7100 | D +1 (503) 892-7304

Ankrom Moisan

Architecture Interiors Planning Brand

[ankrommoisan.com](http://ankrommoisan.com)

**From:** Kristian McCombs <[kristian.mccombs@hdgpd.com](mailto:kristian.mccombs@hdgpd.com)>

**Sent:** Wednesday, May 10, 2023 10:20 AM

**To:** Francis Dardis <[francisd@ankrommoisan.com](mailto:francisd@ankrommoisan.com)>; Eric Jacobson <[ejacobson@reachcdc.org](mailto:ejacobson@reachcdc.org)>; Alex Aleman <[aaleman@reachcdc.org](mailto:aaleman@reachcdc.org)>; Jennifer Nye <[jnye@salazarch.com](mailto:jnye@salazarch.com)>

**Cc:** Andrew Xu <[andrew.xu@hdgpd.com](mailto:andrew.xu@hdgpd.com)>

**Subject:** RE: Elmonica development

Hi Francis,

Looks like the connection point shifted further south than originally coordinated. We'll put this location into our design and get back to you today with updated invert depth.

Kristian McCombs, PE

Associate, Project Engineer

D: 503.946.5358 | O: 503.946.6690

Humber Design Group, Inc.

---

**From:** Francis Dardis <[francisd@ankrommoisan.com](mailto:francisd@ankrommoisan.com)>

**Sent:** Tuesday, May 9, 2023 1:56 PM

**To:** Eric Jacobson <[ejacobson@reachcdc.org](mailto:ejacobson@reachcdc.org)>; Alex Aleman <[aaleman@reachcdc.org](mailto:aaleman@reachcdc.org)>; Jennifer Nye <[jnye@salazarch.com](mailto:jnye@salazarch.com)>; Kristian McCombs <[kristian.mccombs@hdgpx.com](mailto:kristian.mccombs@hdgpx.com)>

**Subject:** Elmonica development

Alex, Eric, Jennifer, Kristian-

One of our "incomplete items is to show the new sanitary easement on our Lot Consolidation Site Plan AND verify that your development is OK with the proposed location. I believe we've located it where HDG requested it a while ago. Their words:

*Show new proposed sanitary sewer easement location on the lot consolidation plan and verify that REACH consents to the relocation. If REACH is planning on connecting to the existing public sewer line location, their plans would need to be modified to accommodate Rembold's proposed relocation.*

See attached Lot Consolidation Site Plan and Civil overall Utility Plan.

Our planner let me know that even an email response (in the affirmative) will suffice for the record.

Thanks...and please don't need any revisions to the location.....

-Francis

**Francis Dardis**

ASSOCIATE PRINCIPAL, AIA

O +1 (503) 245-7100 | D +1 (503) 892-7304

— —

Ankrom Moisan

Architecture Interiors Planning Brand

[ankrommoisan.com](http://ankrommoisan.com)